



Innovative Embedology

Drop Sense
AWLD2400

Addressable Water Leak Detector

Protecting a facility from damaging leaks is an important part of any disaster mitigation plan. C Systems AWLD2400 (Addressable Water Leak Detector) pairs superior leak detection technology with an easy-to-use interface. This integration helps users to quickly and efficiently establish a leak detection system that reliably protects valuable assets.

Technology

The product is designed using High Speed Microprocessor based proprietary technology to locate the water leaks

C Systems designed AWLD2400 with the end-user in mind. All basic device functionality is available from the LCD and membrane keypad to configure, monitor, locate, and acknowledge leaks from the front panel of the AWLD2400. A dedicated mapping name shall be given for every module to quickly locate the leak. The location of leak is displayed in meters along with the mapping name in the panel LCD. This allows the AWLD2400 to be used as a stand-alone device without sacrificing any leak detection or alarm notification functionality.

Once the AWLD2400 is connected to a network via RS485, a robust MODBUS interface expands the capabilities of the unit. Using any BMS interactive facility mapping tool, one can create an interactive overlay that displays on top of an uploaded floor map image. When a leak is detected, the AWLD2400 sends the leak location and other information to the BMS software, making leak location quick and easy.

The AWLD2400 is ideal for applications that require a stand-alone system that can also be integrated into a larger centralized monitoring system.

Features

- Monitor up to 32 Modules
- Not only detects leak, also exact location of leak can be determined.
- Triggers individual Relay output for Alarm and fault and activates common Fire & hooter relays.
- Can access the panel remotely via MODBUS RTU protocol through any BMS software
- Location mapping names can be configured via membrane keypad
- Log an extensive variety of events and alarms

Benefits

- Integrated leak detection and notification. Scalable up to 32 modules
- Pinpoint leaks quickly and accurately
- Manage multiple Room's leak detection system through one RS485 Port or through IP Gateway (optional)
- Detailed alarm history with time and date stamp assists in troubleshooting

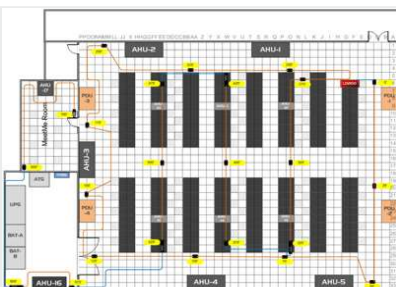

Leak Detection

AWLD2400A Specifications

Power	100-240VAC@ 250mA max
Included Accessories	230V AC 5A Power Cord 2 meters
Inputs	
Module	Compatible with Drop Sense Slave modules AWLDM32
Connection	2 or 4 core 1.5 sq.mm shielded twisted cable
Maximum Length	800 m from Master panel to last slave module
Response time	minimum 250msec / module. (8 sec for 32 modules)
Accuracy	+/- 1.0 m accuracy - minimum (+/- 3% of cable length maximum)
Outputs	
LED Indications	
Power on	Red LED
Alarm	Red LED
Fault	Red LED
Service	Red LED
Relays	Common Alarm, Fault & fire relay Programmable relays
Communication Ports	
Port 01	EIA485 Optically Isolated. Use 1.5 Sq.mm shielded braid cable
Port 02	9600, baud (Default); No parity, 8 bits, 1 stop bit, Optically Isolated
Port 03 (Service)	50000 bps ; For firmware update
Protocols	
EIA-485 (Port 1)	proprietary protocol between Slave monitor modules
EIA-485 (Port 2)	MODBUS RTU between Master panel & BMS gateway
Alarm Notification	
Audible Alarm	Inbuilt buzzer 80dBA @ 1m (3.3ft); External hooter (not included)
Visible Alarm	Alarm indicated on LCD screen and through BMS after integration
Logging Capabilities	
Event Log	Last 100 events
Login Security	
Tack tile Keypad	No password required to view controller status and data. Administrator password limits access to Log events clear.
Front Panel Interface	
Display	4 x 20 character LCD Display
Keypad	4 x 4 Membrane keypad
Operating Environment	
Temperature	0 to 50 Deg C (32 Deg to 122 Deg F)
Humidity	5% to 95% RH, non-condensing
Altitude	15,000ft (4,572m) max.
Storage Environment	20 Deg to 70 Deg C (-4 Deg to 158 Deg F)
Dimensions	250mm(W) x350mm(H) x100mm(D)
Weight	5.0kgs
Mounting	Type 1 wall mount enclosure
Certifications	CE (EN IEC 61010-1:2010 + A1:2019, EN ISO 12100:2010)

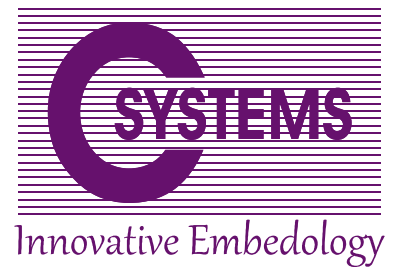

Drop Sense AWLDM32

ADDRESSABLE WATER LEAK DETECTION MODULE

Features

Addressable water leak detection module AWLDM32 is a micro controller based intelligent system. The modules are addressable and can be connected as daisy chain. The module can be powered using SMPS power supply provided in the enclosure. 2x1.5 Sq.mm shielded cable is recommended between Master panel to all modules in Daisy Chain topology. The sensor cable is connected to the module and to be placed any where under false floor.

When the sensor cable detects leak, AWLDM32 Module estimates the distance at which the leak occurred and transport the information to AWLD2400A panel.

Specification

Input voltage:	12V DC, 200 mA (+/- 2%) (SMPS provided in Enclosure)
Communication:	RS485 proprietary protocol. Use 1.5 Sq.mm Shielded braid copper cable
Response time	minimum 7 sec from leak sense to generate alarm in module
Indication:	Audible buzzer during alarm condition, LED indication
Sensor cable:	All Drop sense 2400 sensor cable
Maximum length:	100m per module
Mounting:	DIN RAIL mountable
Module Dimension:	120mm (H) x 70mm (W) x 75mm (D)
Module Weight:	600 g
Enclosure Weight:	1.6 Kgs
Certifications	CE (EN IEC 61010-1:2010 + A1:2019, EN ISO 12100:2010)

Dr  **p Sense**

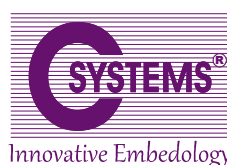

No:122, 1st Floor, BHEL Nagar, Kundrathur Main Road,
Madanathapuram, Chennai 600116. INDIA.
9952667680, 9941006680, 9841157607
E-mail: sales@csystemsindia.com;
www.csystemsindia.com

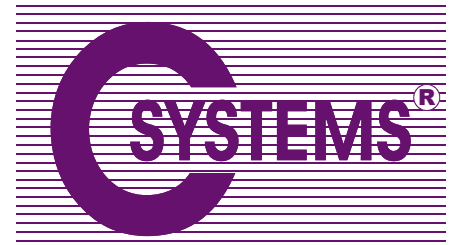

Innovative Embedology



Drop Sense

AWLD sensor cable

Features

C Systems Drop Sense sensing cable is used to reliably sense the presence of water. The sensing cable is durable, easy to clean, fast drying, and able to resist damage from most contaminants. The cable's abrasion-resistant polymer core increases its strength and durability. The cable is constructed from nonconductive materials to help eliminate false alarms

When connected to a AWLD2400 panel, the sensing cable detects the presence of water and also pinpoints the exact location of the fluid along the cable route. Sensing cable is available in standard and custom lengths. Each end of the cable is factory constructed end of line circuit to make installation of leak detection systems quick and easy. Drop Sense sensing cable offers a reliable leak detection solution that mitigates potential water damage, costly business outages, and downtime.

AWLD Sensor Cable Specifications

Sheer Strength	>81.65kg. (>180 lbs)
Cut Through Resistance	>18.14kg. (>40 lbs) with 0.127mm (0.005in) blade
Dimension:	5.5mm dia.
Maximum sensor cable run:	100m
Weight:	28 g /m
Panel:	Drop Sense AWLD 2400
Country of origin:	INDIA
Certifications	CE (EN IEC 61010-1:2010 + A1:2019, EN ISO 12100:2010)

Models Available:

Sensing Cable Length (add type to above code)

- 10M 10 meters (32.81ft)
- 15M 15 meters (49.21ft)
- 20M 20meters (65.62ft)
- 25M 25 meters (82.02ft)

Custom lengths available on request *

Drop Sense

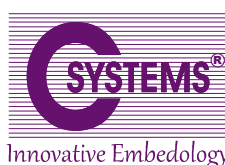

No:122, 1st Floor, BHEL Nagar, Kundrathur Main Road,
Madanathapuram, Chennai 600116. INDIA.
9952667680, 9941006680, 9841157607
E-mail: sales@csystemsindia.com;
www.csystemsindia.com